

Polyx

Polyethylene snowplough



Bucher Municipal
Giletta SpA
Via A. De Gasperi, 1
I-12036 Revello (CN)
tel. +39 0175 258 800

info.it@buchermunicipal.com

www.buchermunicipal.com

At Bucher Municipal, we innovate and engineer better cleaning and clearing solutions, helping our customers grow and maintain efficient and profitable businesses. Leveraging the over 200-year-old heritage of Bucher, we are committed to helping you achieve more using less. Taking pride in being seen as a reliable partner, we work locally with you in realising the possibilities for a smarter, cleaner and more efficient tomorrow. Today.



● Bucher Municipal locations
● Distribution Partners

BMU_6p_POLYX_rev0 - 03/2021 - The technical data and pictures are indicative and not binding.

Polyethylene HD snowploughs

From heavy trucks to small implement carriers and tractors, from light to heavy snowfalls, from harsh surface to airport runways.

You can choose between 4 different main body sizes and 29 blade lengths in total. Starting from light 1,4m S plough for clearing private property and sidewalks, all the way to 4,5m M models for most demanding tasks. There is always a model of Polyx that suits you or can be configured to your needs, depending on truck size, average snowfall and clearing strategy.

Arm your tool with scraper blade which will do best snow clearance without need of sup-

porting wheels and without damaging the road surface.

Now you can choose between our innovative Neotech 2S flexible scraping blade or double scraping blade system with second blade made of anti-wear hard steel which can be lowered hydraulically. With double scraper system every road condition can be treated successfully.

As final upgrade the all new patented MBS system will inject brine directly through the neoprene scraping blade multiplying clearing results.

Driven by better

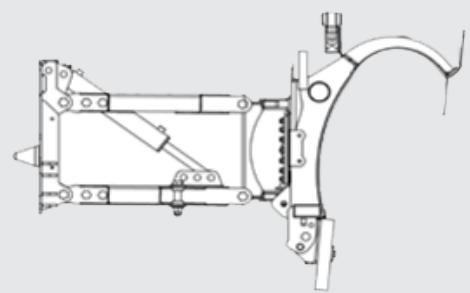

Neoprene scraping blade

Neoprene blade with bi-shore structure: its profile adapts perfectly to the road surface, not generating noise with asphalt or other pavements, respecting the regulations in force.

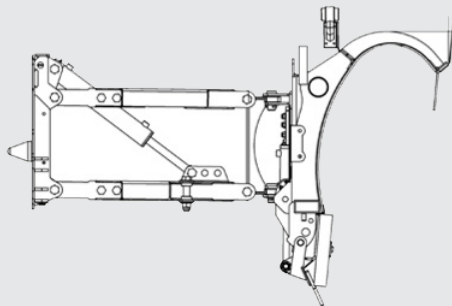

Double scraping blade in neoprene + steel

Depending on the type of snow, you can choose from the cab whether to use the steel or neoprene blade. The steel blade is able to pass through obstacles thanks to the Hardox400 anti-wear steel.

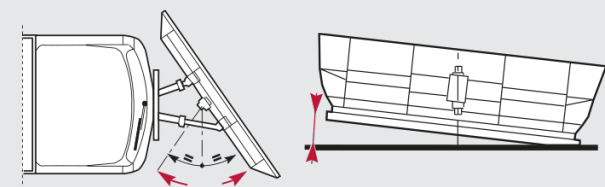

Oscillation and rotation

Two polyurethane inserts keep the elevator locked in a perfect horizontal position when the blade is raised and make it completely free to follow the road surface when the blade is lowered in the working position. Angulation from -32° to +32°.

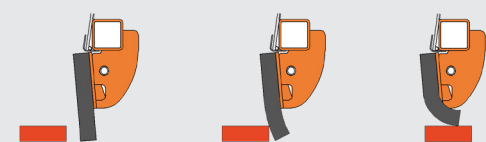

Obstacle overcoming system with neoprene blade

In case of impacts against fixed obstacles, the elasticity of neoprene blades allows their deformation, according to EN13021 standard, easily overcoming the obstacle, and allows their immediate return to the working position, without any shock.

Technical Data		S	R	L	M
Scraper blade length	mm	1400 to 2600	2600 to 3400	2800 to 4000	3200 to 6200
Clearing width	mm	1200 to 2250	2300 to 2850	2470 to 3540	2850 to 5410
Minimum size for narrow passages	mm	1260 to 2320	2490 to 2995	2710 to 3730	2950 to 5490
Weight	Kg	215 to 330	315 to 460	505 to 770	795 to 1200
Center of gravity	mm	325 to 510	420 to 710	845	515 to 940
Shield height - front / sides	mm	650/800	805/935	955/1095	1145/1240

Painting
Special sandblasting painting cycle, certified 2000h in salt spray.

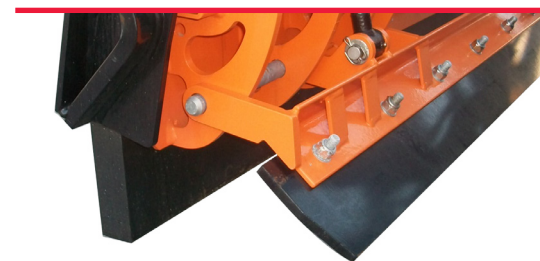

Second scraping blade in Hardox400 anti-wear steel (opt)
Electro-hydraulic control direct from the driver cab. Hydro-pneumatic override protection included.

Bi-shore neoprene scraping blade
Ideal for every type of snow, especially for fresh or wet snow.

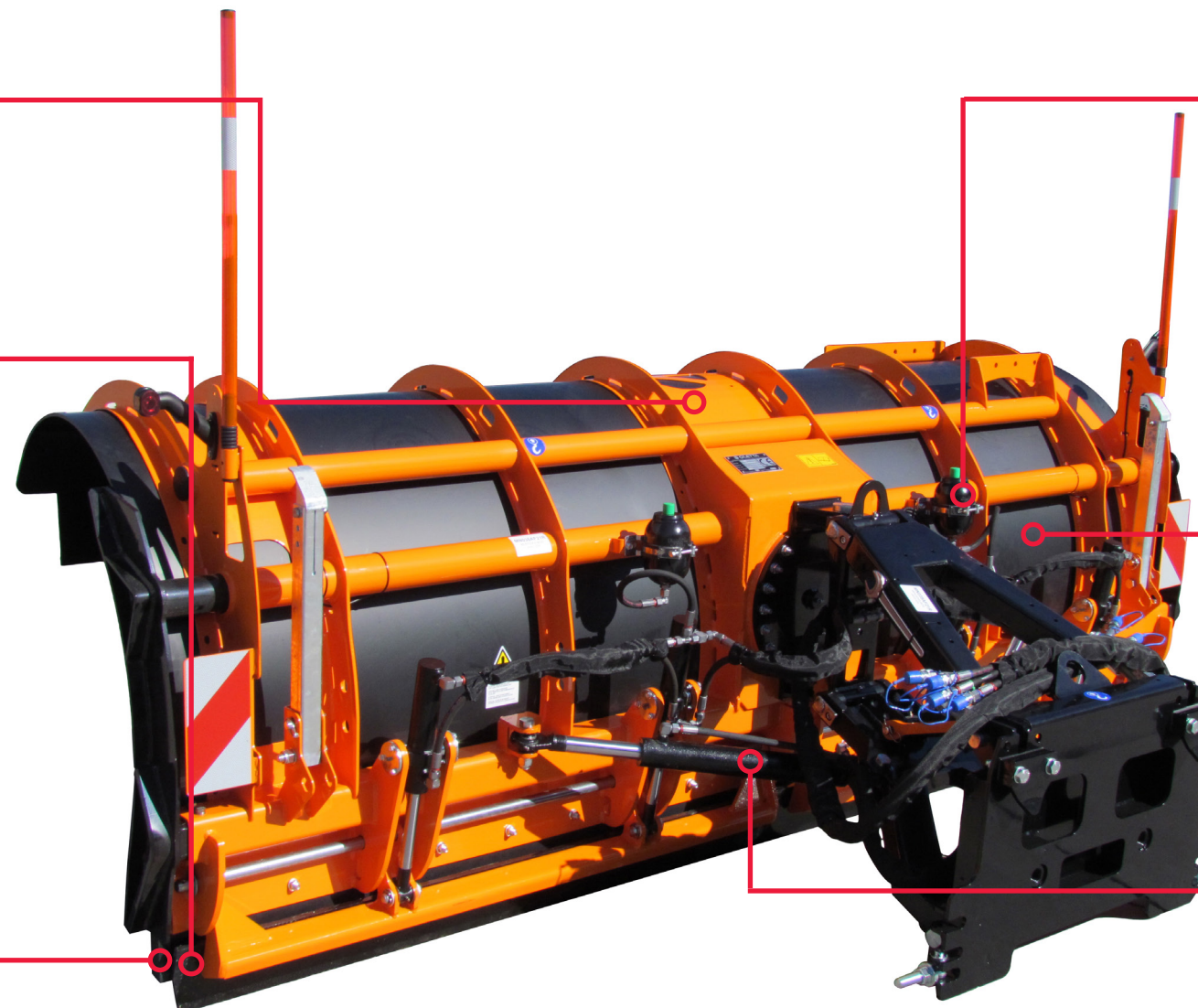

Automatic lighting system (opt)
A lighting electronic system is available to adjust the plough pressure on the road from the cab, in order to avoid an excessive wear of the scraping edge.



Polyethylene HD Shield
Open and rounded profile, enabling to eject large amounts of snow. It reduces fuel consumptions and vehicle wear thanks to lower adhesion of snow on the mouldboard.

Rotation pistons and by-pass valve
A safety by-pass valve, inserted in the rotation hydraulic circuit, enables the absorption of lateral impacts.



Electro-hydraulic control unit (opt)
Installed on the plough mounting plate when vehicle is not provided with own hydraulic system.

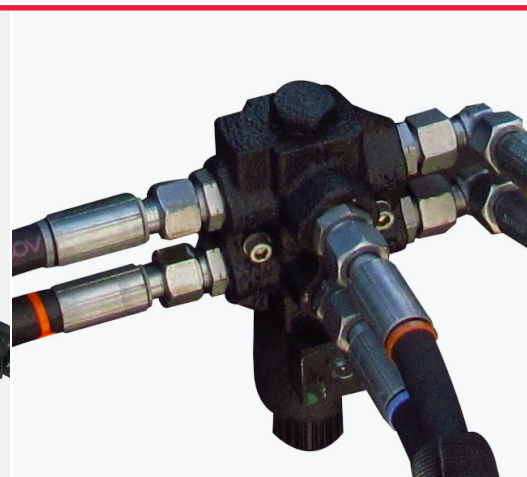

Duplicator/triplicator valve (opt)
In case of missing hydraulic function, an hydraulic duplicator/triplicator allows to rise the number of plough functions from the cab control.



Auxiliary spotlight kit (opt)
In compliance with current traffic regulations, they back-up the vehicle lights and indicators and are adjustable.

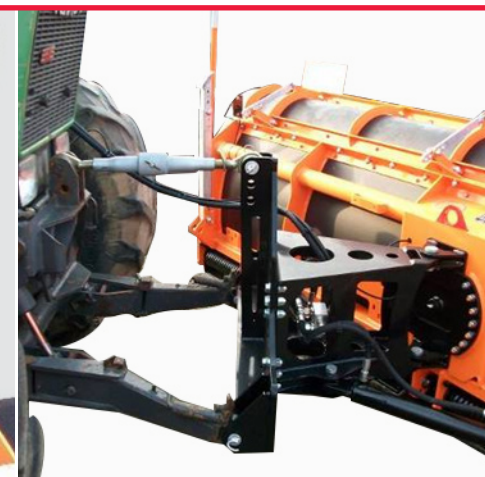

3 point connection (opt)
For farm tractors available in Cat. 1, 2 and 3.



Special parking feet (opt)
This system allows to store the plough with the scraping cutting edge unloaded (lifted from ground).

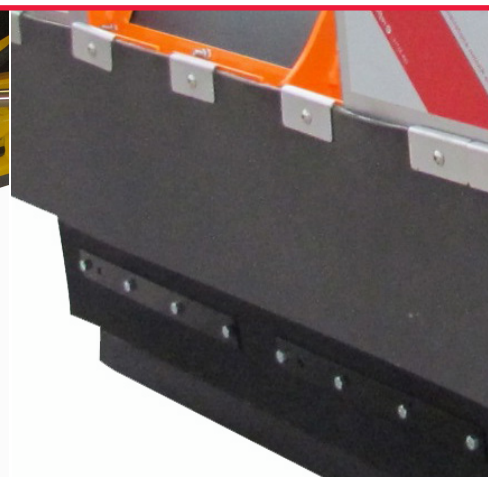

Rubber splashguard
It avoids snow splashing on the vehicle windscreen.