

Grow your business with Teesside University

Access our wide range of support



**AMBITION
DELIVERED
TODAY**



WELCOME

At Teesside University we believe that innovation powers our steps to create a world where everyone benefits from progress.

'Focused on making a real difference in the lives of people and the success of business and the economy, we challenge expectations and push the boundaries of what is possible. We approach challenges at pace and with purpose. We do not stand still.

We are an ambitious and enterprising university for a focused and pragmatic global new generation. We provide real opportunities and support to realise potential on a campus fit for the future and around the world.

From developing outstanding degree apprenticeships tailored to industry to addressing societal challenges on a global scale, our work is always relevant and purpose-driven. We value education and research which is innovative, creative and supports the development of solutions to realworld challenges.

We work with individuals and businesses to develop solutions that deliver ambition today. If you have the drive to make a difference and the skills, knowledge, and experience to help us shape the future, we want to work with you.'

Professor Craig Gaskell
Pro Vice-Chancellor
(Enterprise & Knowledge Exchange)

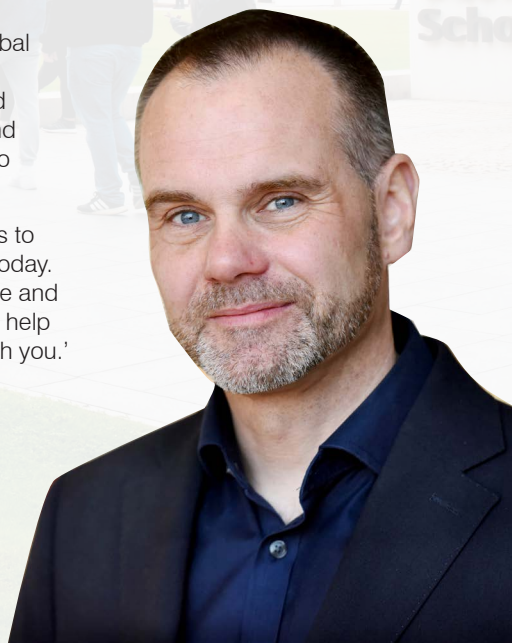

Contents

- 2 **Why work with Teesside University?**
- 4 **Workforce development**
 - Professional Apprenticeships
 - Continuing Professional Development (CPD) courses
 - Online Learning
- 6 **Research and innovation**
 - Consultancy
 - Knowledge Transfer Partnerships (KTPs)
 - Collaborative Studentships
 - Net Zero Industry Innovation Centre
 - National Horizons Centre
- 11 **Recruiting talent**
- 12 **Funded support**
 - Innovate UK Business Growth
- Facilities**
- 14 **Get in touch**



WHY WORK WITH TEESSIDE UNIVERSITY?

Innovation experts: Our academic experts are ready to collaborate with you, applying their research to solve your business challenges. We'll connect you with the right specialists and help secure the funding needed to drive your projects forward.

Skills and knowledge development: developing skills and knowledge is at the heart of what we do. Working closely with industry, we ensure our workforce development programmes address your specific needs.

Flexible learning options: our programmes are developed to meet current and future industry needs. Whether you require a one-day masterclass to refresh skills, or a full degree studied part-time, online, or through an apprenticeship, we can support your business with various flexible delivery options.

Access fresh talent: our students and graduates bring fresh ideas, up-to-date knowledge, and enthusiasm. We facilitate placements, internships, and part-time employment to help you tackle business problems and innovate. Advertise your vacancies with us to reach over 20,000 potential candidates, with our experienced recruitment team matching the best talent to your needs.



Expand your network: our network is extensive; leverage it to connect with businesses, technology and funding agencies, and specialist networks globally. We can open doors to new markets and technologies, creating opportunities for growth and collaboration.

Benefit from impactful research: our research delivers real-world impact, addressing socio-economic and environmental challenges. Most of our research impact was assessed as world-leading or internationally excellent in the Research Excellence Framework (REF) 2021*. Our commitment to impactful research ensures that your business benefits from cutting-edge insights and solutions.

*Find out more at tees.ac.uk/source



‘At Teesside University, we are dedicated to fostering innovation and driving progress. Our collaborative approach ensures that businesses benefit from cutting-edge research and expertise, helping them to overcome challenges and seize new opportunities.’

Steph Bales,
Director of Research & Enterprise

WORKFORCE DEVELOPMENT

Professional Apprenticeships

Accelerate skill development: our apprenticeships are co-designed with employers to build a workforce that meets your business needs. These programmes combine cutting-edge research and practical experience, ensuring your team stays relevant to industry practices. Funded through the Apprenticeship Levy, they offer a cost-effective way to enhance your workforce's capabilities.

Attract new talent: our apprenticeships are an excellent way to attract fresh talent to your business. By offering apprenticeship programmes, you can tap into a diverse pool of motivated individuals eager to learn and grow within your organisation. These programmes not only bring in new perspectives and ideas but also allow you to train potential future employees in alignment with your business values and objectives, ensuring a strong fit and long-term commitment.

Find out more:



“Our professional apprenticeships are designed to equip your team with the skills and knowledge they need to excel. By partnering with us, you’ll ensure your business remains competitive and innovative.”

Jo Burgess, Director of Professional Apprenticeships

Continuing Professional Development (CPD)

We offer a range of CPD options to suit your business needs. From intensive one-day masterclasses designed to address specific skills requirements and minimise time away from work, to longer, sector-specific training programmes for more in-depth learning, we have the flexibility to meet your needs.

We also bring our expertise to you, providing in-house training programmes for groups of your employees requiring particular skills. This helps reduce time and travel costs, ensuring training is efficient and effective. If you don't see the programme you're looking for on our website, just get in touch. We'll work with you to develop tailored learning packages, delivered where, how, and when you need them.

Find out more:



Online Learning

We offer a broad range of flexible online learning courses designed to fit around other commitments, putting learners in control of pace and place.

Online learning allows your workforce to earn a university-level qualification from anywhere in the world, without having to physically attend our campus. They can access lectures, tutorials, and assessments online, fitting their studies around work commitments.

Find out more:



We use cutting-edge digital tools and platforms to provide an outstanding student experience, promoting collaboration between learners across the globe.



“Our online learning programmes provide your team with the flexibility to gain new skills and qualifications without disrupting their work schedules, driving growth and innovation in your business.”

Emma Adcock, Director of Teesside University Online Learning



“I chose to study the HND to support my job role as a Technical Field Advisor. I chose the distance learning option to work around my current role. I work away from home, so I spend a lot of time travelling and staying in hotels and I have enjoyed filling those free hours with something challenging and rewarding.”

Andrew Webster, Higher National Diploma in Mechanical Engineering



RESEARCH AND INNOVATION

We are in the heart of Teesside; a cornerstone of the community driving regional growth. We collaborate with community groups, policymakers, charities, SMEs, and industry to address key challenges and generate regional prosperity.

Our research is framed by three core institutional themes:

- > **net zero**
- > **health and well-being**
- > **people and place.**

We're excellent at what we do: most of our research impact was assessed as world-leading or internationally excellent in the Research Excellence Framework (REF) 2021*. This means our research is world-leading in originality, significance and rigour. With a globally relevant approach, we support recovery, regeneration, and renewal, transforming both local and international economies.

Consultancy

Address knowledge gaps in your workforce by tapping into our vast expertise. We'll work with you to understand your challenges and develop flexible, tailored solutions.

We collaborate with businesses of all sizes, in both the private and public sectors, connecting you with our academics who are at the forefront of industry needs. Our experts can help develop projects, provide proof of concept, and evaluate processes and technologies to drive your business forward.

Find out more:



Knowledge Transfer Partnerships (KTPs)

A KTP is a world-leading programme that connects your business to world-leading academic expertise and resources. The programme forges partnerships between businesses, the university, and a recently qualified graduate – known as an associate to help you innovate and grow.

As the North East's joint top university provider of KTPs (Innovate UK*), we help you develop strategic projects using our expertise and knowledge, by embedding an associate to work on-site in your organisation.

Find out more:



'The company undertook a KTP, primarily because it gave us access to equipment and technologies, we don't have in-house. The project provided analytical insight into how we run our fermentations at Quorn. It's work we wouldn't have been able to do in-house, so we needed the university's experts to provide guidance. As a result, we are becoming much more data-driven in what we do on-site.'

Dr Mark Taylor,
Fermentation Lead at Marlow Foods



Collaborative studentships

Collaborative PhD studentships address real-world problems. Work with dedicated PhD students and academic supervisors on bespoke research projects tailored to your organisation's needs.

Benefits include:

- > working with a dedicated PhD student to co-develop a bespoke, high-quality research project tailored to your organisation's needs
- > gain access to leading-edge facilities, equipment, and expertise
- > receive support and expert input from a team of academic supervisors
- > give your organisation a competitive edge through investment in research and innovation
- > forge a long-term collaborative relationship with Teesside University and stay connected to cutting-edge research and high-quality research training.

Find out more:



Net Zero Industry Innovation Centre

At the £13.1m Net Zero Industry Innovation Centre (NZIIC), we're helping businesses transition to a cleaner, greener future. We provide the tools, expertise, and resources needed to thrive in the sustainability era. Our five cutting-edge labs, specialising in hydrogen, circular economy, smart energy, carbon capture, utilisation and storage, and digitalisation, offer a collaborative space for innovation. By partnering with us, you can leverage our industrial heritage and state-of-the-facilities to redefine your industry and drive impactful change.

Find out more:



||

'In partnership with the Net Zero Industry Innovation Centre, Rounton Coffee Roasters is committed to advancing its commitment to sustainable operations. By optimising delivery routes and embracing innovative strategies, we're minimising our carbon footprint while enhancing efficiency.'

David Beattie,
Managing Director at
Rounton Coffee Roasters



National Horizons Centre

At the National Horizons Centre (NHC), we support the global biosciences and healthcare sector with cutting-edge research and development. Located in Darlington, our £22.3m centre of excellence helps businesses discover diseases earlier, develop novel treatments, and deliver life-changing medicines more quickly, safely, and affordably. We bring together industry, academia, talent, and world-class facilities to create real-world impact. Our approach combines research, partnerships, and training to drive innovation.



'The North East has a thriving biosciences sector that is globally competitive, vibrant, and viable. Our collaboration with the National Horizons Centre enables us to draw on the best of research, workforce development, innovation and manufacturing to enable companies to develop, prove, scale up and manufacture new products that will improve the quality of life of people around the world.'

Frank Millar, CEO at CPI

Find out more:



RECRUITING TALENT

Access top talent: tap into our pool of over 20,000 students and thousands of alumni. Our customised recruitment service helps you find the right candidates for your business needs.

Student and graduate placements: engage with our students through placements, funded graduate internships, and graduate-level roles to bring fresh perspectives and up-to-date knowledge into your organisation.

Get involved: help nurture future talent and promotes your business to potential future employees. Your business could support our region's next generation by getting involved in our initiatives, whether that's career fair stands, guest lectures, live briefs, or workshops.

Find out more:

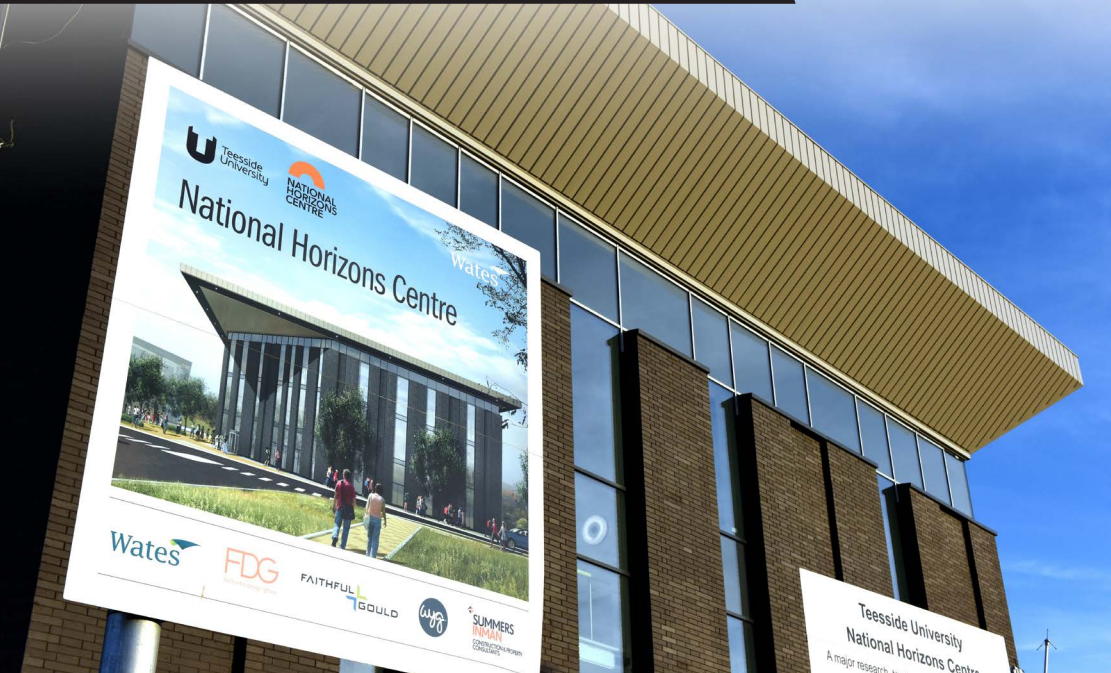

FUNDED SUPPORT

Innovate UK Business Growth

Grow and scale your business: as part of the Innovate UK Business Growth consortium, we provide advisory services to help your innovative business grow and scale. Our specialists offer tailored advice, resource access, and support in securing funding and expanding into new markets.

Strategic development: we assist you in developing innovation strategies, protecting intellectual property, and enhancing investor appeal. Our goal is to empower your business to succeed nationally and internationally.

Find out more:



FACILITIES

Teesside University can support you with access to specialist, purpose-built facilities to help your business innovate, test new products, train employees or produce quality audio-visual material.

Find out more:



GET IN TOUCH

Speak to our team. Discover how Teesside University can add value to your business.

Contact us at **business@tees.ac.uk** or visit **tees.ac.uk/business** to learn more and make an enquiry. Let's work together to unlock your business potential.

Teesside University

Middlesbrough

Tees Valley

TS1 3BX UK

T: +44 (0) 1642 218121

tees.ac.uk